

FEATURES

- AS/NZS 4020 approved FBE coating.
- Ductile iron body.
- 316 Teflon® coated stainless steel tie rods.
- Fully restrained and unrestrained configurations.
- Longitudinal ± 25 mm adjustment for sizes up to 750mm.
- Longitudinal ± 30 mm adjustment for sizes above 800mm.

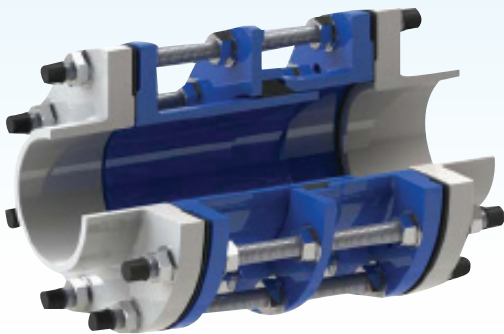

AFD10 SERIES

DISMANTLING JOINTS

DN50-DN1400

AVFI's AFD10 dismantling joints are fittings that provide easy installation and disassembly of flanged pipe and associated equipment including valves, meters and pumps. The AFD10 are widely used for a variety of industries.



APPLICATIONS

- NBR seal
- Wide selection of fastener materials and finishes:
 - Galvanized fasteners
 - 304 stainless steel
 - Dacromet® coating on fasteners
 - Galvanized steel 4.8 or 8.8
- Flange drilling connections to suit a wide range of flanging standards:
 - AS2129 T/ E
 - ANSI 150 - Drilling Only
 - EN 1092
- PN25 pressure rating

TECHNICAL DATA

| | |
|-----------------------------------|--|
| Size Range | DN80 - DN1400 - Large sizes available on request |
| Pressure Class | PN16 |
| Coating | AS/NZS 4020 Approved, Fusion Bonded Epoxy |
| Temperature Range | -10°C to 80°C |
| Flange Drilling Connection | AS4087 CL16 |

AFD10 SERIES

DISMANTLING JOINTS

The operating principle behind the AFD10 is that the centre sealing flange is drawn closer to the mating flange, thereby compressing the rubber sealing ring to achieve a complete seal. So simple, yet so efficient and practical.

The AFD10 features a single tie rod connecting all three flanges. It is recommended to check with your local authority to confirm that the AFD10 is permitted for your application.

TYPICAL APPLICATIONS

- The dismantling joints are designed to simplify the installation, maintenance and removal of:
 - Isolation valves
 - Non-return valves
 - Control valves
 - Metering & associated equipment
 - Pumps & associated equipment
- The dismantling joints are used in many areas, including:
 - Pumping stations
 - Water treatment plants
 - Sewage treatment plants
 - Industrial pipelines
- A traditional dismantling joint, supplied with a complete set of tie rods as 100% restrained, though on request can be supplied as either 25% or 50% restrained.

Operates Via Single Combined Tie Rods

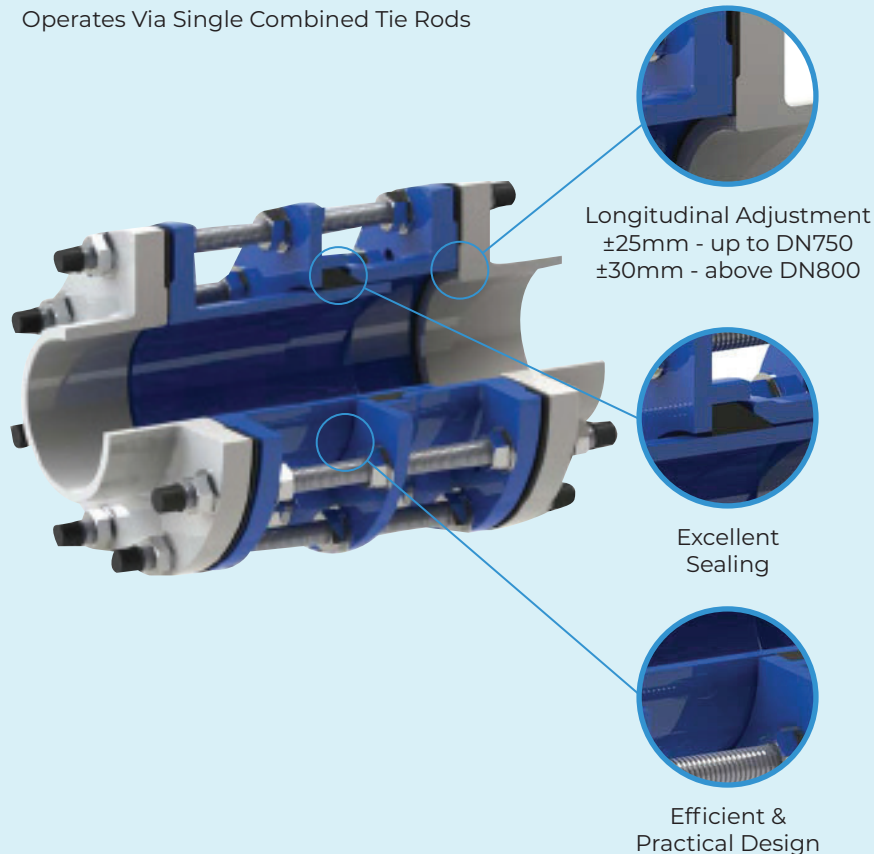

AFD10 SERIES

DISMANTLING JOINTS

MATERIAL SPECIFICATIONS & PARTS LIST

| NO. | DESCRIPTION | MATERIAL |
|-----|--------------------|---------------------------|
| 1 | Long Flanged Body | Ductile Iron |
| 2 | Short Flanged Body | Ductile Iron |
| 3 | Middle Flange | Ductile Iron |
| 4 | Seal Ring | EPDM (AS1646 Approved) |
| 5 | Stud | SS316 with Teflon Coating |
| 6 | Washer | SS316 |
| 7 | Nut | SS316 |

| NOMINAL PRESSURE | | PN16 |
|------------------|---------------|----------|
| Test | Strength Test | 24 Bar |
| Pressure | Strength Test | 17.6 Bar |

DIMENSIONAL DRAWING

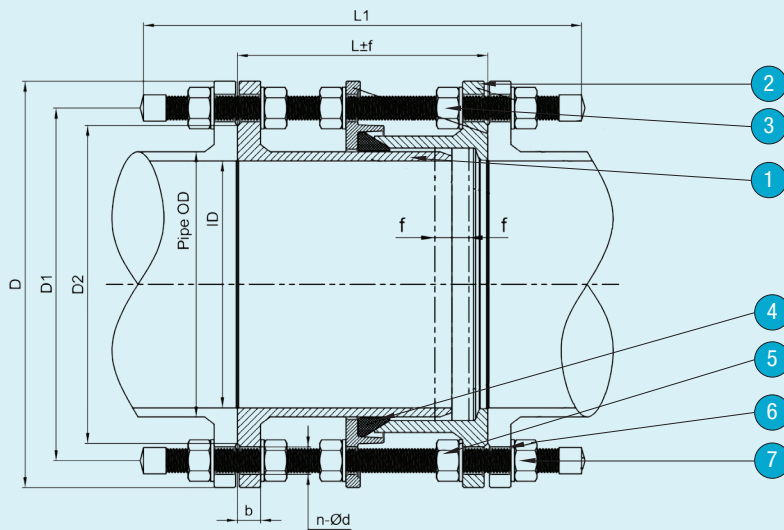

Figure 3. Restrained AFD10 Dismantling Joint

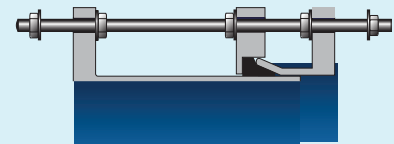
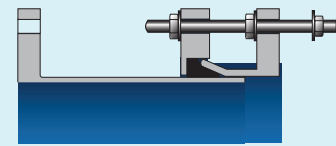

Figure 4. Unrestrained AFD10 Dismantling Joint



DIMENSIONS (MM)

| DN | ID | LENGTH | | ADJUSTMENT | AS4087 PN16 | | | | b | M | NO. OF TIE-bar | | |
|------|------|--------|-----|------------|-------------|------|------|-------|------|------|----------------|----------------|-----------------|
| | | L | L1 | f | D | D1 | D2 | n-d | | | 25% Restrained | 50% Restrained | 100% Restrained |
| 50 | 44 | 195 | 310 | ±25 | 150 | 114 | 90 | 4-18 | 19 | M16 | | | 4 |
| 65 | 52 | 195 | 310 | ±25 | 165 | 127 | 103 | 4-18 | 19 | M16 | | | 4 |
| 80 | 83 | 195 | 340 | ±25 | 185 | 146 | 122 | 4-18 | 19 | M16 | | | 4 |
| 100 | 101 | 195 | 340 | ±25 | 215 | 178 | 154 | 4-18 | 19 | M16 | | | 4 |
| 125 | 125 | 200 | 340 | ±25 | 255 | 210 | 186 | 8-18 | 19 | M16 | | | 8 |
| 150 | 154 | 200 | 350 | ±25 | 280 | 235 | 211 | 8-18 | 19 | M16 | | 4 | 8 |
| 200 | 206 | 210 | 350 | ±25 | 335 | 292 | 268 | 8-18 | 20 | M16 | | 4 | 8 |
| 225 | 230 | 220 | 380 | ±25 | 370 | 324 | 300 | 8-18 | 20 | M16 | | | 8 |
| 250 | 258 | 220 | 380 | ±25 | 405 | 356 | 328 | 8-22 | 22 | M20 | | 4 | 8 |
| 300 | 307 | 230 | 400 | ±25 | 455 | 406 | 378 | 12-22 | 24.5 | M20 | 3 | 6 | 12 |
| 350 | 359 | 240 | 410 | ±25 | 525 | 470 | 438 | 12-26 | 26.5 | M24 | 3 | 6 | 12 |
| 375 | 395 | 250 | 430 | ±25 | 550 | 495 | 463 | 12-26 | 28 | M24 | 3 | 6 | 12 |
| 400 | 408 | 250 | 430 | ±25 | 580 | 521 | 489 | 12-26 | 28 | 1M24 | 3 | 6 | 12 |
| 450 | 456 | 265 | 450 | ±25 | 640 | 584 | 552 | 12-26 | 30 | M24 | 3 | 6 | 12 |
| 500 | 508 | 275 | 460 | ±25 | 705 | 641 | 609 | 16-26 | 31.5 | M24 | 4 | 8 | 16 |
| 550 | 575 | 285 | 500 | ±25 | 760 | 699 | 637 | 16-30 | 35 | M27 | | | 16 |
| 600 | 613 | 290 | 500 | ±25 | 825 | 756 | 720 | 16-30 | 36 | M27 | 4 | 8 | 16 |
| 700 | 711 | 295 | 510 | ±25 | 910 | 845 | 809 | 20-30 | 39.5 | M27 | 5 | 10 | 20 |
| 750 | 764 | 320 | 530 | ±25 | 995 | 927 | 888 | 20-33 | 41 | M30 | 5 | 10 | 20 |
| 800 | 817 | 320 | 560 | +30 | 1060 | 984 | 942 | 20-36 | 43 | M33 | 5 | 10 | 20 |
| 900 | 911 | 320 | 580 | +30 | 1175 | 1092 | 1050 | 24-36 | 46.5 | M33 | 6 | 12 | 24 |
| 1000 | 1012 | 325 | 600 | +30 | 1255 | 1175 | 1133 | 24-36 | 50 | M33 | 6 | 12 | 24 |
| 1200 | 1216 | 340 | 640 | +30 | 1490 | 1410 | 1368 | 32-36 | 57 | M33 | 6 | 16 | 32 |
| 1400 | 1420 | 340 | 640 | +30 | 1680 | 1615 | 1573 | 36-36 | 50 | M33 | 9 | 18 | 36 |

AFD10 SERIES

DISMANTLING JOINTS

AFD10 RECOMMENDED BOLT TIGHTEN TORQUE FOR AS4087 CL16 (N.M)

| SIZE | BOLT SIZE | BOLT NO. | TORQUE 1 | TORQUE 2 (SEALING) |
|--------|-----------|----------|----------|--------------------|
| DN50 | M16 | 4 | 100 | 100 |
| DN65 | M16 | 4 | 100 | 100 |
| DN80 | M16 | 4 | 100 | 100 |
| DN100 | M16 | 4 | 100 | 100 |
| DN150 | M16 | 8 | 100 | 80 |
| DN200 | M16 | 8 | 100 | 80 |
| DN225 | M16 | 8 | 100 | 80 |
| DN250 | M20 | 8 | 180 | 150 |
| DN300 | M20 | 12 | 180 | 150 |
| DN350 | M24 | 12 | 320 | 210 |
| DN375 | M24 | 12 | 320 | 210 |
| DN400 | M24 | 12 | 320 | 210 |
| DN450 | M24 | 12 | 320 | 240 |
| DN550 | M24 | 16 | 320 | 240 |
| DN600 | M27 | 16 | 440 | 280 |
| DN750 | M27 | 20 | 440 | 280 |
| DN800 | M33 | 20 | 735 | 350 |
| DN900 | M33 | 24 | 735 | 350 |
| DN1000 | M33 | 24 | 735 | 370 |
| DN1200 | M33 | 32 | 735 | 400 |
| DN1400 | M33 | 36 | 800 | 400 |

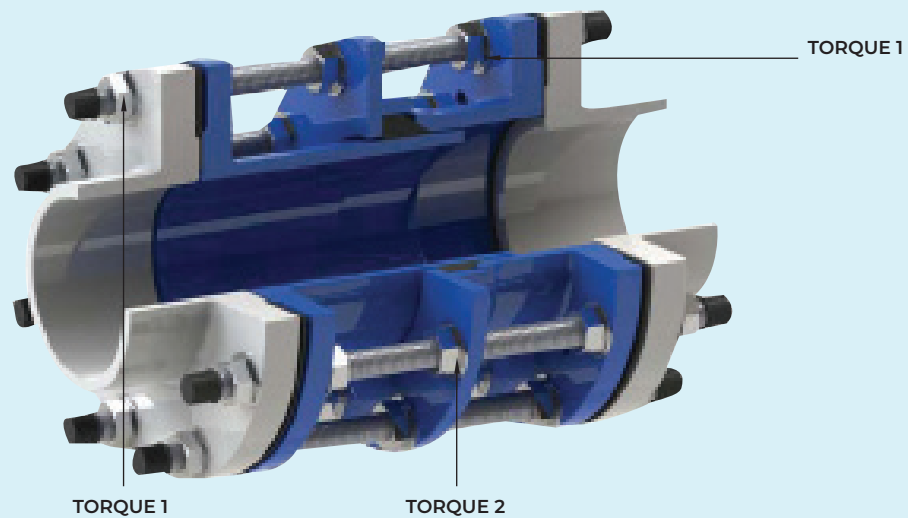

ORDERING CHART

| MODEL | SIZE | BOLTS | RESTRAINED | ATTACHMENT |
|-------|------|-------|------------|---------------|
| AFD10 | -050 | 316 | 025 | T/D - Table D |
| | -065 | 304 | 050 | T/E - Table E |
| | -080 | GAL | 100 | ANSI 150* |

EXAMPLE

AFD10 80mm 316 Bolts 025 Restrained Table E
 AFD10-080-316-025-T/E

* ANSI 150 Drilling only. PN rating as per standard valve.